



Precision Meter Data

TS10AF

Electronic Flow Meters

MODELS: TS10AF14, TS10AF64, TS10AF84

TS series oval gear positive displacement precision meters offer weights and measures accuracy for fluid custody transfer. The patented "Wave Form" oval gear design provides smooth and accurate operation in the meters only two parts. Refer to Precision Meter Technical Manual or Precision Meter Price book for complete list of options.



TS10AF14

Specifications

Capacity with standard LV rotors

Standard 5:1 Turn-down **Industrial** 10:1 Turndown

To 1500 SSU visc. (300cP) | 40 gpm (150 lpm)

Pressure Rating

Meter | 150 PSI at 100°F = 10 BAR at 40°C

Temperature Rating

Meter | -40°F to +180°F = -40°C to +80°C

Viscosity

With LV rotors | 100% capacity to 1,500 SSU (300 cP)

With HV rotors | 100% capacity to 5,000 SSU (1000 cP)

Connections

Standard | 1" Bolted companion flanges with NPT or BSP port.

Optional | Bolted welding flanges
Bolted 150# RF ANSI adaptors, carbon steel

Pulse Options

Raw Pulse
100 PPG
10 PPL

Materials

Case	Anodized aluminum
Gears	PPS with carbon bearings, PTFE bearings opt.
Posts	Hard chromed 303 Stainless steel
Seals	Viton™ standard, PTFE optional.
Flanges	Anodized aluminum std., carbon steel optional.

Measurement Approvals

NTEP	99-210
MID	GB-1366 TC8183

Safety Approvals

Electronics Enclosure	Flame proof/explosion proof enclosure for use in a hazardous location Class I, Division 1, Zone 1. Intertek approved (ETL) US and Canada. ATEX, IECEx.
SCL	Telemetering equipment for use in Hazardous Locations, Class 1, Division 1, Group D for US. UL approved.
TBB	Intrinsically Safe Apparatus for Class I, II and III, Division 1 for US and Canada. Intertek Approved (ETL) US and Canada.
CE	Approved





Excellence at work.
Excellence in life.

Model Number Options

TS									
10		10	1"	25 mm	40	2,400	150	9	
A	A	Anodized Aluminum Material							
Assembly Number	A	NPT							
Flange	B	BSP							
Rotors & Seals									
Signal Conditions									
ATEX Gland	A	ATEX Gland							
Languages									

	Seals	Rotors	Bearings
A	Viton	LV	PPS/Carbon
V	Viton	HV	PPS/Carbon
B	PTFE	LV	PPS/Carbon
D	PTFE	HV	PPS/Carbon
H	PTFE	HV	PPS/PTFE

E	English
S	Spanish
X	Not Applicable

F14		Meter Only - Register ready
F64		Meter Only - with EMR3 Register
F84		Meter Only - with MID:COM register

Volt		
1	EMR3	TBB
4	MID:COM	TBB
T	5-24	TBB ~1768 PPG
G	5-12	100 PPG SCL
L	5-12	10 PPL SCL
H	24	100 PPG SCL
K	24	10 PPL SCL

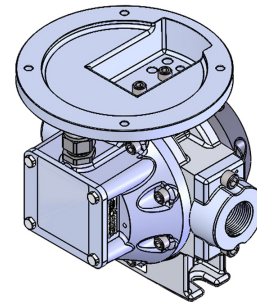
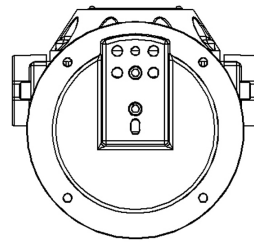

TS10AF14

