

# FILL-RITE®

The Most Trusted Name in Pumps and Meters



## FR311VLN Technical Specifications

### Motor

|                                 |                  |
|---------------------------------|------------------|
| Power - AC 115,230, 115/230 VAC | 115/230          |
| HZ 50,60,50/60                  | 60/50            |
| Power - DC 12, 24, 12/24        | N/A              |
| HP (Horsepower) Rating          | 3/4 HP           |
| Power Cord Length (feet)        | N/A              |
| Power Cord Gauge (AWG)          | N/A              |
| DC Power Cord Connectors        | N/A              |
| Amps (FLA)                      | 9.8/4.9 11.4/5.7 |
| RPM                             | 1725/1425        |
| Duty Cycle                      | 30 min.          |
| Thermal Protection Switch       | Yes              |
| Circuit Protection Fuse         | None             |
| Certification                   | UL, cUL          |

### Pump

|                                      |   |
|--------------------------------------|---|
| Type - Rotary, Diaphragm, Gear, Vane | Rotary Vane   |
| GPM in Supplied Configuration        | 26.6  |
| GPM Open Flow - no Hose or Nozzle    | 34.3  |
| By-Pass Pressure Rating (PSI) - Max  | 26 PSI  |
| Dry Vac (in Hg)                      | 14  |
| Head - Max (Ft.)                     | 60.06   |
| Anti-Siphon Valve                    | Anti-Siphon Ready                                     |
| Inlet - Size / Thread                | 1.25"   |
| Outlet - Size / Thread               | NPT   |
| Mount                                | Bung  |
| Material - Pump Housing              | Cast Iron   |
| Material - Wetted Material           | Fluorocarbon / Buna                                   |
| Rotor Material                       | Bronze  |
| Rotor Vane Material                  | Carbon  |
| Compatible Fluids                    | Diesel, Gasoline, Bio-Diesel up to B20, E15, Kerosene |
| Max Viscosity of Fluids to Pump      | 22cSt   |
| Strainer Mesh Size                   | .04"  |
| Warranty                             | 2 Years   |

### SERVICE KIT INFORMATION

| Kit      | Description         | Parts   |
|----------|---------------------|---|
| KIT300BD | Bio-Diesel Kit      | Special shaft seal assembly, gasket, inlet gasket, bypass O-ring                                |
| KIT300BV | Bypass Kit          | Poppet, spring, O-ring, cap   |
| KIT300JC | Junction Box        | Junction box cover, O-ring, hardware  |
| KIT120NB | Nozzle Boot Kit     | Nozzle boot, attaching hardware   |
| KIT300NR | Nozzle Retainer Kit | Nozzle retainer and attaching hardware  |
| KIT700BG | Inlet Kit           | Inlet adapter, AST 2 x 1 1/4  |
| KIT300SG | Switch Lever        | Switch lever and nut  |
| KIT120NB | Nozzle Boot Kit     | Nozzle boot, attaching hardware   |
| KIT300RG | Rotary Group        | Rotor, 8 vanes, rotor key, gasket, rotor cover, 4 screws  |
| KIT300SL | Shaft Seal          | 8 piece assembly  |
| KIT300OT | Outlet Kit          | Outlet flange, O-ring seal, attaching hardware  |
| KIT700AS | Anti-Siphon Kit     | Anti-siphon valve, Teflon tape, elbow adapter, stainless steel braided hose, attaching hardware |



Excellence at work. Excellence in life.

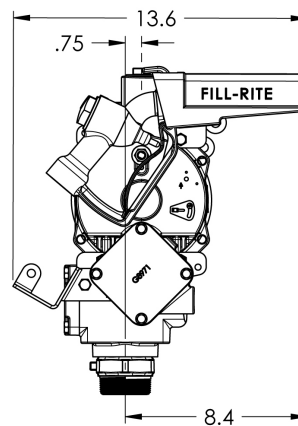
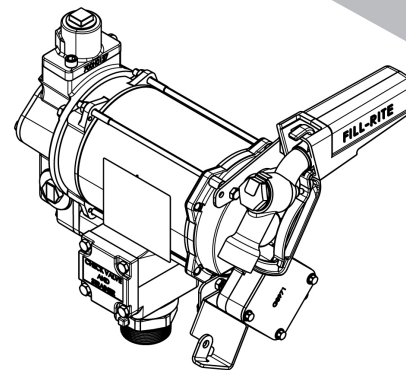
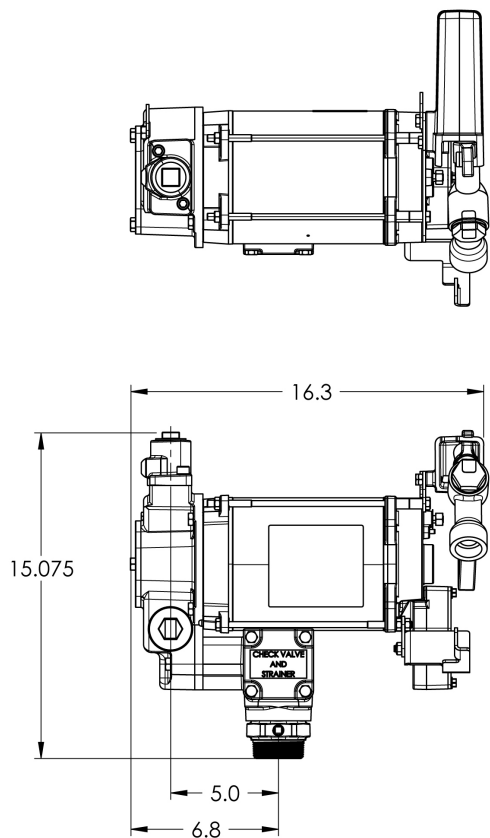

| Accessories                   |                      | Measurements                                |         |
|-------------------------------|----------------------|---|---------|
| Suction Pipe Material         | N/A                  | Overall Height                              | 19.4"   |
| Suction Pipe Length           | N/A                  | Overall Width                               | 17"     |
| Nozzle - Size                 | 1" Ultra High Flow   | Overall Depth                               | 17"     |
| Nozzle - Manual / Automatic   | Ultra High Flow      | Intake Center Line to Discharge Center Line | 2"      |
| Hose Diameter                 | 1"                   | Intake Center Line to Back of Nozzle Boot   | 8.5"    |
| Hose Length                   | 12'                  | Shipping Weight                             | 94 lbs. |
| Hose Material of Construction | Black Nitrile Rubber | Qty per Pallet                              | 8       |
| Hose Static Wire (Yes/No)     | Yes                  | Box Dimensions:                             |         |
| Certifications                | UL, cUL              | Length                                      | 21"     |
|                               |                      | Width                                       | 20"     |
|                               |                      | Height                                      | 18"     |

