

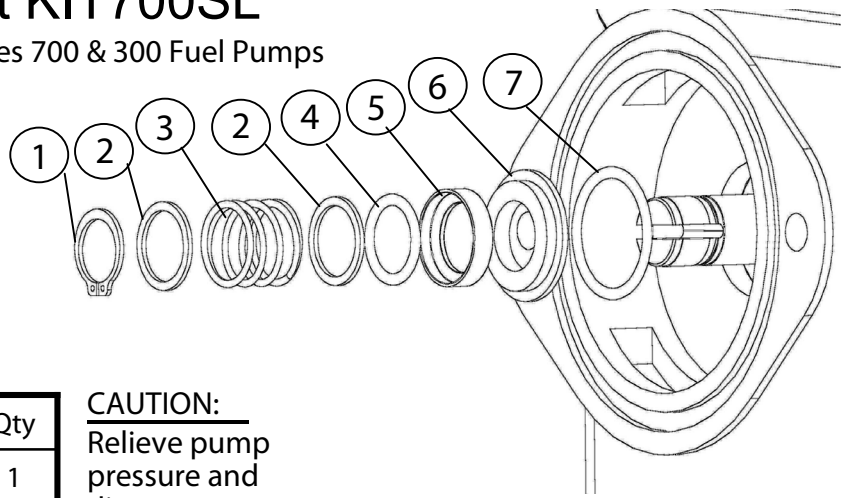

Seal Kit KIT700SL

for Fill-Rite series 700 & 300 Fuel Pumps



No.	Description	Qty
1	Retaining ring	1
2	Washer (plated)	2
3	Spring (ss)	1
4	-114 O-ring (FKM)	1
5	Metal Seal Ring (ss)	1
6	Carbon Seal Ring	1
7	-120 O-ring (FKM)	1

CAUTION:

Relieve pump pressure and disconnect power before working on pump. To ease installation the components have been assembled in order of installation on the cardboard tube.

INSTRUCTIONS. Carefully remove old seal components and clean out pump seal bore. Pump seal bore and shaft must be clean and free of scratches for proper seal performance. Follow the steps illustrated below to install new seal.

